

**REGISTERED SURVEYOR'S CERTIFICATION**

It is certified that the locations, levels and dimensions of the infrastructure shown herein are a true representation of the constructed works and that the as-constructed survey was performed to the prescribed accuracy standards.

Registered Surveyors Name: Stephen Kelly (Authorised Delegate) Registration Number: 6338.  
 Registered Surveyors signature: [Signature] Date: 14/04/2022.  
 Company Title: Brisbane Survey Group Pty Ltd.

**AS-CONSTRUCTED WORKS**

IT IS CERTIFIED THAT WORKS HEREIN HAVE BEEN CONSTRUCTED TO RELEVANT APPROVED SPECIFICATIONS AND THE OPERATIONAL WORKS APPROVAL. THE AS-CONSTRUCTED DRAWINGS FOR THESE WORKS CONSTITUTE A TRUE AND CORRECT RECORD OF THE WORKS CONSTRUCTED AND COMPLY WITH THE DESIGN INTENT.

SIGNATURE: [Signature] RPEQ No: 9424  
 DATE OF PRACTICAL COMPLETION: 22/04/2022  
 COMPANY TITLE: EMPOWER ENGINEERS AND PROJECT MANAGERS  
 NOTE: ALL AS CONSTRUCTED INFORMATION SHOWN IN RED AND DENOTED WITH AN "X"

Scale 1:250 - Lengths are in Metres.

**LAWSON SURVEYS**  
 A.B.N 46 272 949 047  
 CONSULTING LAND SURVEYORS  
 9B / 62 BISHOP STREET  
 KELVIN GROVE QLD 4059  
 Ph 07 3352 3326 Fax 07 3352 6991  
 mail@lawsonsurveys.com.au  
 www.lawsonsurveys.com.au

Amendments		DETAILS
ISSUE	DATE	INITIAL VERSION
A	14/04/2022	

PLAN:  
**PLAN OF AS CONSTRUCTED DRAINAGE**  
 CLAY GULLY STAGE 2  
 CLAY GULLY ROAD, VICTORIA POINT

OPW NUMBER:	OPW21/0089	SCALE:	1:250
LGA:	REDLAND CITY COUNCIL	DATUM:	AHD
SUBURB:	VICTORIA POINT	DATE OF SURVEY:	28/03/2022
ORIGIN:	MGA	SURVEYED BY:	LAWSON SURVEYS
		DRAWN BY:	QSD

CLIENT:	URBEX	ISSUE	A
PLAN REFERENCE:	20361-2-SW	SHEET	1 OF 3







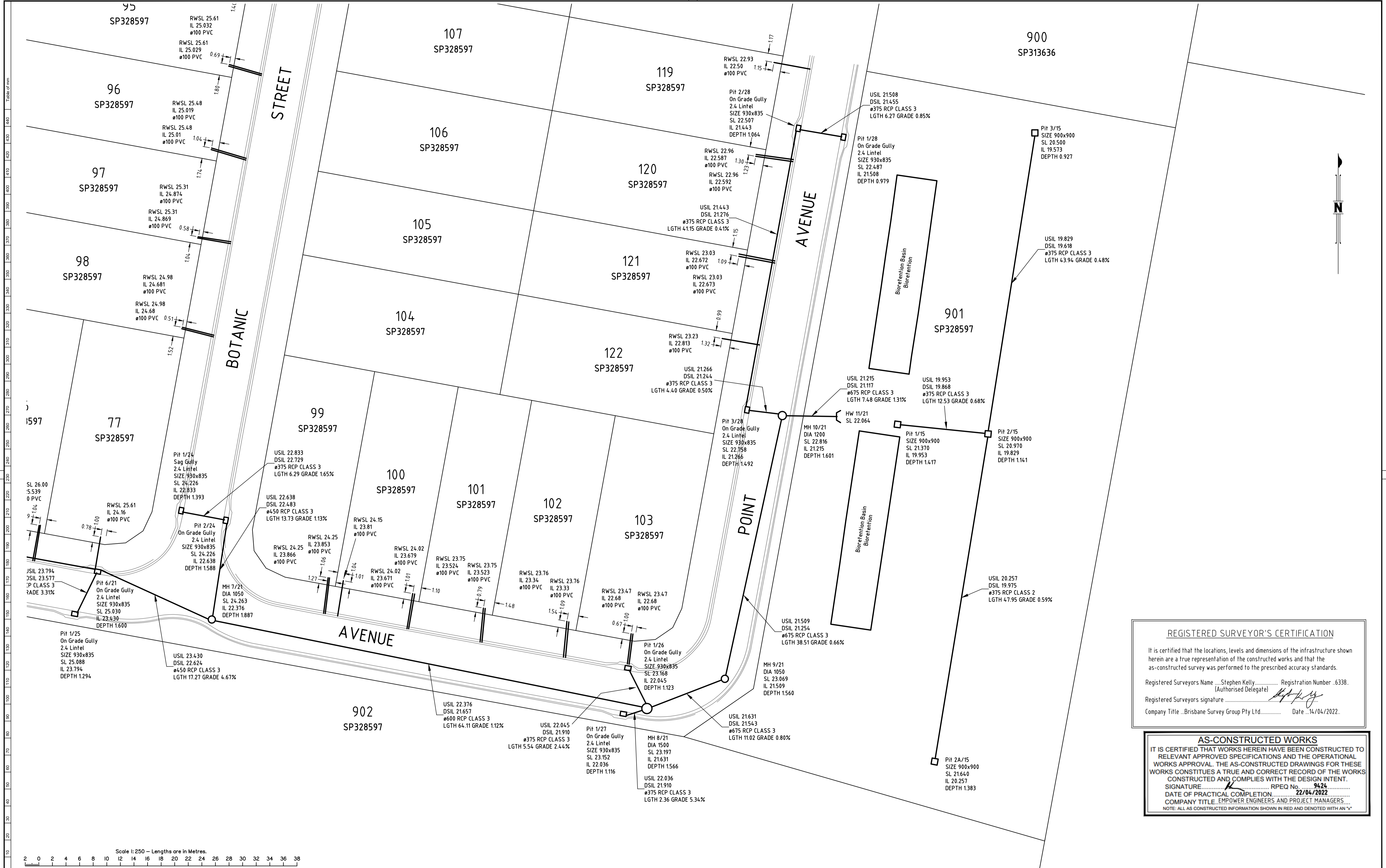

**LAWSON SURVEYS**  
 A.B.N 46 272 949 047  
 CONSULTING LAND SURVEYORS  
 9B / 62 BISHOP STREET  
 KELVIN GROVE QLD 4059  
 Ph 07 3352 3326 Fax 07 3352 6991  
 mail@lawsonsurveys.com.au  
 www.lawsonsurveys.com.au

Amendments		
ISSUE	DATE	DETAILS
A	14/04/2022	INITIAL VERSION

PLAN:  
**PLAN OF AS CONSTRUCTED DRAINAGE**  
**CLAY GULLY STAGE 2**  
**CLAY GULLY ROAD, VICTORIA POINT**

OPW NUMBER: OPW21/0089  
 LGA: REDLAND CITY COUNCIL  
 SUBURB: VICTORIA POINT  
 ORIGIN: MGA

SCALE: 1:250  
 DATUM: AHD  
 DATE OF SURVEY: 28/03/2022  
 SURVEYED BY: LAWSON SURVEYS  
 DRAWN BY: QSD

CLIENT: **URBEX**  
 PLAN REFERENCE: **20361-2-SW**

ISSUE: **A**  
 SHEET: **3 OF 3**

**REGISTERED SURVEYOR'S CERTIFICATION**

It is certified that the locations, levels and dimensions of the infrastructure shown herein are a true representation of the constructed works and that the as-constructed survey was performed to the prescribed accuracy standards.

Registered Surveyors Name: Stephen Kelly Registration Number: 6338.  
 (Authorised Delegate)  
 Registered Surveyors signature: *[Signature]*  
 Company Title: Brisbane Survey Group Pty Ltd. Date: 14/04/2022.

**AS-CONSTRUCTED WORKS**

IT IS CERTIFIED THAT WORKS HEREIN HAVE BEEN CONSTRUCTED TO RELEVANT APPROVED SPECIFICATIONS AND THE OPERATIONAL WORKS APPROVAL. THE AS-CONSTRUCTED DRAWINGS FOR THESE WORKS CONSTITUTES A TRUE AND CORRECT RECORD OF THE WORKS CONSTRUCTED AND COMPLIES WITH THE DESIGN INTENT.

SIGNATURE: *[Signature]* RPEQ No. 9424  
 DATE OF PRACTICAL COMPLETION: 22/04/2022  
 COMPANY TITLE: EMPLOYER ENGINEERS AND PROJECT MANAGERS  
 NOTE: ALL AS CONSTRUCTED INFORMATION SHOWN IN RED AND DENOTED WITH AN "A"

